

Internally cooled submersible pump for clear and drainage water.

BOZO EMD series pumps are mini construction dewatering pumps. With their compact & modular construction, these pumps are best suited for pumping wastewater from pits, cellar drainage, portable dewatering etc.,

■ **Mode of operation:**

The BOZO EMD model is capable of permanent & portable operations. Automatic float switch option is available for automatic pumping operation.

■ **Design & Construction:**

The BOZO EMD is a fully submersible integrated motor-pump unit consisting of the following.

■ **Pump:**

Single stage centrifugal pump with outlet size of 50mm (2.0") & 80mm (3.0")

■ **Impeller:**

SV type - Semi-Vortex impeller for clear, drainage or construction water with solid handling capacity of 6mm.

■ **Motor:**

Thermal sensors are embedded with the winding.

■ **Cable:**

The cable connection chamber is isolated from the motor housing completely. Cable used - HO7RN-F | Cable length - 8m

■ **Shaft / Bearing:**

Stainless steel shaft / ball bearings.

■ **Seals:**

Combination of mechanical seal is used in a separated oil chamber. Oil level can be checked from outside.

■ **Technical data:**

Motor power : 0.5 & 1.0 HP
 Voltage : 1 Phase (220V - 240V),
 Frequency : 50 Hz
 Insulation : F Class
 Motor protection : IP68
 Max. Liquid temp. : 40°C

■ **Material of Construction:**

Component	Material
Hose coupling, Up-bearing housing, Seal house & Pump body	Cast iron
Impeller	Ductile Iron
Upper cover, Motor body	Aluminum die cast
Mechanical seal	Ceramic-Sic/ Carbon-Ceramic
Shaft	SS 420
Handle	Rubber & Stainless steel
Agitator	Stainless steel



■ **Applications:**

- ▶ Civil and Domestic building Sites
- ▶ Rainwater dewatering
- ▶ Mud / Sand water
- ▶ Swimming pools
- ▶ Basement / Utility pits
- ▶ Fish ponds

■ Performance curve:

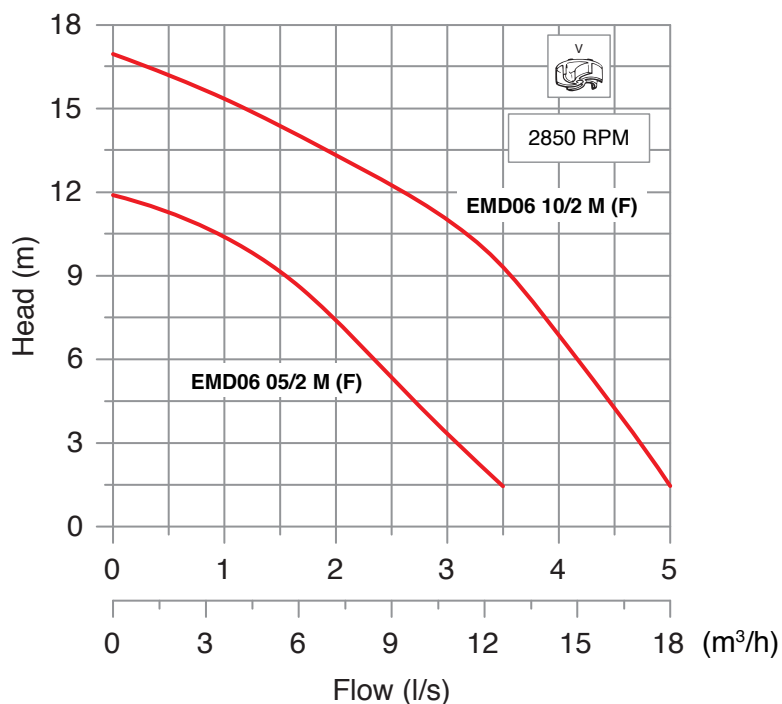

■ Technical table:

Curve no.	Pump model	Motor Power			Nominal Current (A)	Capacitor (µF)	Speed (rpm)	Solid Handling Capacity (mm)	Weight (kgs)
		P1 (kW)	P2 (kW)	HP					
1	EMD06 05/2 M (F)	0.5	0.37	0.5	3.0	-	2850	6	15
2	EMD06 10/2 M (F)	1.0	0.75	1.0	5.0	-	2850	6	19

* **EMD06** - Series name, 06 - Solid handling capacity, | **XX/X** - Motor power/No. of poles
M - 230-240 V/1 Ph | **T** - 400-415V/3 Ph | **F** - Float switch

■ Dimensional drawing:

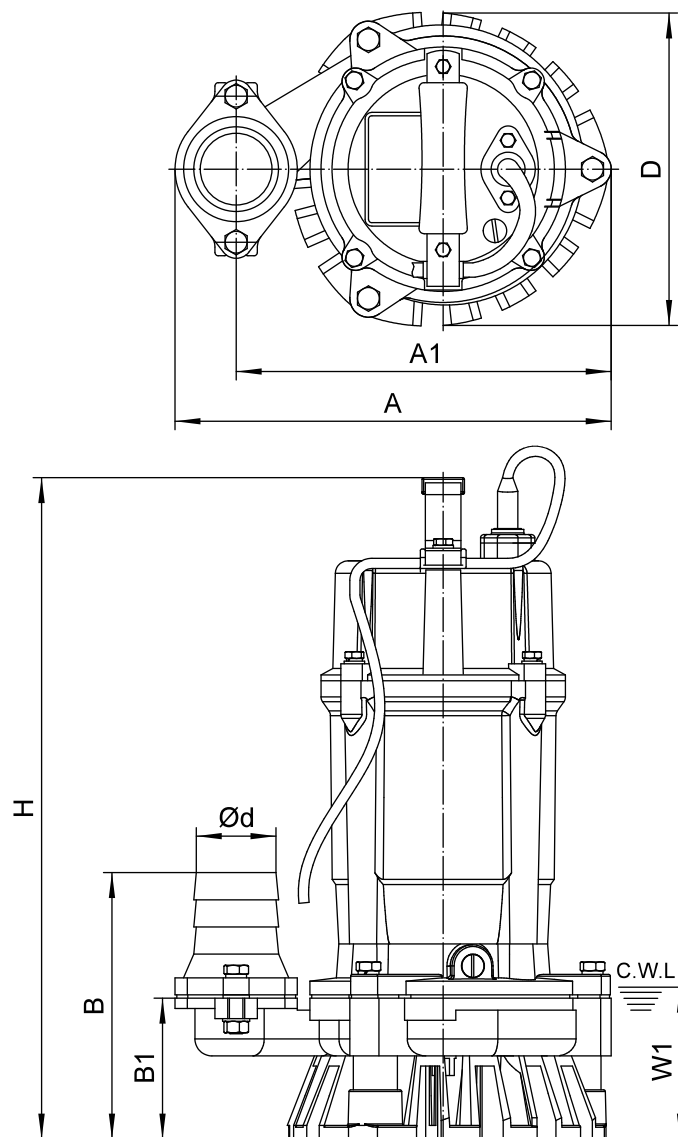

* C.W.L - Continuous running water level

■ Dimension details:

Pump model	d (mm)	A (mm)	A1 (mm)	B (mm)	B1 (mm)	D (mm)	H (mm)	W1 (mm)
EMD06 05/2 M (F)	50	237	201	157	84	185	365	85
EMD06 10/2 M (F)	80	284	234	215	109	185	390	85