

Electric submersible pump for wastewater containing solids of 30 and 42 mm.

EKKI LINUS 30 series pumps are suitable for pumping soiled, drainage and wastewater. With their large free passage of 30 & 42 mm, they are particularly well suited to pump liquids with large solids (Ex : Textile fibers)

■ **Mode of operation:**

The LINUS 30 model is capable of permanent & portable operations. Automatic float switch option is available for automatic pumping operation. This float control option is provided depending on the level of liquid in the sump.

■ **Design & Construction:**

The LINUS 30 is a compact & fully submersible integrated motor-pump unit consisting of the following.

■ **Pump:**

Single stage centrifugal pump with outlet size of 50mm (2.0")

■ **Impeller:**

M type - Open single channel impeller for wastewater containing impurities and sludge with solid particles.

V type - Vortex impeller for wastewater containing high level of impurities, fibers and solids.

■ **Motor:**

Thermal sensors are embedded with the winding.

■ **Cable:**

The cable connection chamber is completely isolated from the motor housing

Cable used - HO7RN-8F | Cable Length - 10m

■ **Shaft / Bearing:**

Large diameter stainless steel shaft, pre-lubricated bearings.

■ **Seals:**

Combination of mechanical seals and lip seals in a separate oil chamber.



Technology by



■ **Technical data:**

Motor power : 1.0 - 2.0 HP  
 Voltage : 1 Phase (220V - 240V),  
 3 Phase (380V - 415V)  
 Frequency : 50 Hz  
 Insulation : H Class  
 Motor protection : IP68  
 Max. Liquid temp. : 40°C

■ **Material of Construction:**

| Component                      | Material         |
|--------------------------------|------------------|
| Motor & Pump housing, Impeller | Cast iron FG 260 |
| Mechanical seal / Lip seal     | SiC-SiC / NBR    |
| Rotor shaft                    | SS 431           |
| Fasteners                      | SS 304, NBR      |

■ **Applications:**

- ▶ STP & ETP
- ▶ Muddy water
- ▶ Cow dung & Poultry wastewater
- ▶ Textile wastewater
- ▶ Hotel wastewater
- ▶ Water with large fibers
- ▶ Septic Tanks
- ▶ Sump water
- ▶ Basement water

■ Performance curve:

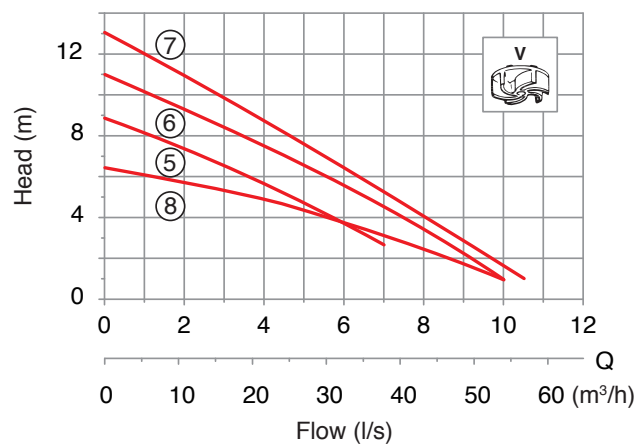
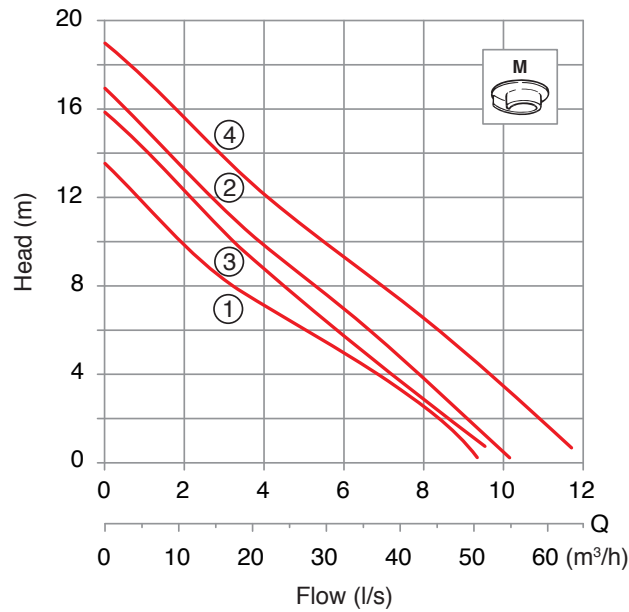

\* Curve 1-7 : 2900 RPM  
Curve 8 : 1450 RPM

■ Technical table:

| Curve no. | Pump model       | Motor Power |         |     | Nominal Current (A) | Capacitor (µF) | Speed (rpm) | Solid Handling Capacity (mm) | Weight (kgs) |
|-----------|------------------|-------------|---------|-----|---------------------|----------------|-------------|------------------------------|--------------|
|           |                  | P1 (kW)     | P2 (kW) | HP  |                     |                |             |                              |              |
| 1         | ES30M 10/2 M (F) | 1.0         | 0.7     | 1.0 | 4.3                 | 25             | 2900        | 30                           | 28           |
| 8         | ES30V 10/4 M (F) | 1.0         | 0.7     | 1.0 | 5.0                 | 30             | 1450        | 42                           | 29           |
| 8         | ES30V 10/4 T (F) | 1.0         | 0.7     | 1.0 | 2.3                 | -              | 1450        | 42                           | 29           |
| 3         | ES30M 15/2 T (F) | 1.2         | 0.9     | 1.5 | 2.1                 | -              | 2900        | 30                           | 28           |
| 5         | ES30V 15/2 M (F) | 1.2         | 0.9     | 1.5 | 5.1                 | 25             | 2900        | 30                           | 28           |
| 5         | ES30V 15/2 T (F) | 1.2         | 0.9     | 1.5 | 2.1                 | -              | 2900        | 30                           | 28           |
| 2         | ES30M 20/2 M (F) | 1.6         | 1.2     | 2.0 | 7.5                 | 30             | 2900        | 30                           | 29           |
| 4         | ES30M 20/2 T (F) | 1.6         | 1.2     | 2.0 | 2.9                 | -              | 2900        | 30                           | 29           |
| 6         | ES30V 20/2 M (F) | 1.6         | 1.2     | 2.0 | 7.5                 | 30             | 2900        | 30                           | 29           |
| 7         | ES30V 20/2 T (F) | 1.6         | 1.2     | 2.0 | 2.9                 | -              | 2900        | 30                           | 29           |

\* ES30M/V - ES30 - Pump model, M/V - Impeller type | XX/X - Motor power/No. of poles | M - 230-240 V/1 Ph | T - 400-415V/3 Ph  
F - Optional float switch | Capacitor - Capacitor for applicable models is installed in the pump

■ Dimensional drawing:

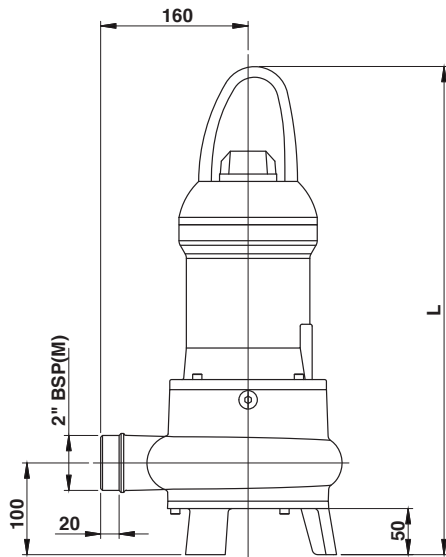

| MODEL          | L   |
|----------------|-----|
| ES30(M/V) XX/2 | 530 |
| ES30V 10/4     | 545 |

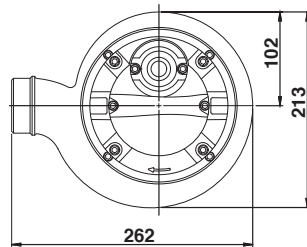

■ Pump accessories drawing:

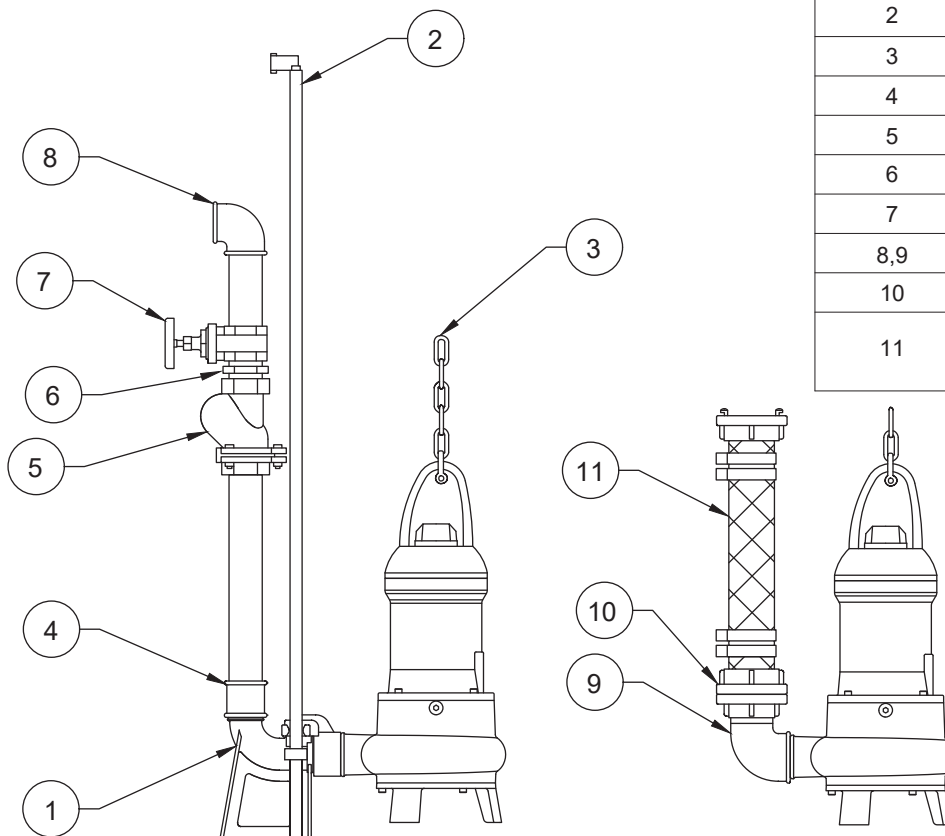

| Balloon No. | Item Description                      | Specification |
|-------------|---------------------------------------|---------------|
| 1           | Auto coupling kit                     | 2"            |
| 2           | Guide rail (G.I or SS)                | Ø0.5" , Ø1"   |
| 3           | Pump chain                            | -             |
| 4           | G.I nipple                            | 2"            |
| 5           | Cast swing check valve                | BSP 2"        |
| 6           | G.I nipple                            | BSP 2"        |
| 7           | Gate valve MS                         | BSP 2"        |
| 8,9         | 90° elbow GI                          | BSP 2"        |
| 10          | STORZ coupling                        | BSP 2"        |
| 11          | Synthetic pressure hose with coupling | Ø52 mm        |