

Electric submersible pump for waste water containing solids of up to 50 - 65mm.  
 EKKI LINUS 50V series pumps are suitable for pumping textile, chemical and fibrous wastewater. With their large free passage of 50 and 65mm, they are particularly used for industrial, public & private wastewater.

■ **Mode of operation:**

The LINUS 50V model is capable of permanent & portable operations. Automatic float switch option is available for automatic pumping operation. This float control option is provided depending on the level of liquid in the sump.

■ **Design & Construction:**

The LINUS 50V is a sturdy & fully submersible integrated motor-pump unit consisting of the following.

■ **Pump:**

Single stage centrifugal pump with outlet size of 50mm (2.0") & 65mm (2.5")

■ **Impeller:**

V type - Vortex impeller for wastewater containing high level of impurities, fibers and solids with solid handling capacity of 50 - 65 mm.

■ **Motor:**

Thermal sensors are embedded with the winding.

■ **Cable:**

The cable connection chamber is completely isolated from the motor housing  
 Cable used - HO7RN-8F | Cable Length - 10m

■ **Shaft / Bearing:**

Large diameter stainless steel shaft, pre-lubricated bearings.

■ **Seals:**

Combination of mechanical seals are used in a separated oil chamber (models above 1.8 kW). Models up to 1.6 kW, combination of mechanical seal and lip seals is used. Oil inspection from outside.



■ **Technical data:**

Motor power : 1.0 - 6.0 HP  
 Voltage : 1 Phase (220V - 240V),  
 3 Phase (380V - 415V)  
 Frequency : 50 Hz  
 Insulation : H Class  
 Motor protection : IP68  
 Max. Liquid temp. : 40°C

■ **Material of Construction:**

Component	Material
Motor & Pump housing, Impeller	Cast iron FG 260
Mechanical seal / Lip seal	SiC-SiC / NBR
Rotor shaft	SS 431
Fasteners	SS 304, NBR

■ **Applications:**

- ▶ Hotel wastewater
- ▶ STP & ETP
- ▶ Building services
- ▶ Chemical Industries
- ▶ Pharma Industries
- ▶ Sludge wastewater
- ▶ Fish ponds
- ▶ Water with long fibres
- ▶ Poultry wastewater

■ Performance curve:

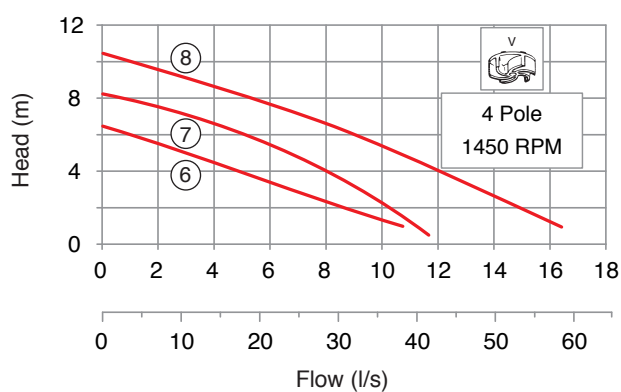
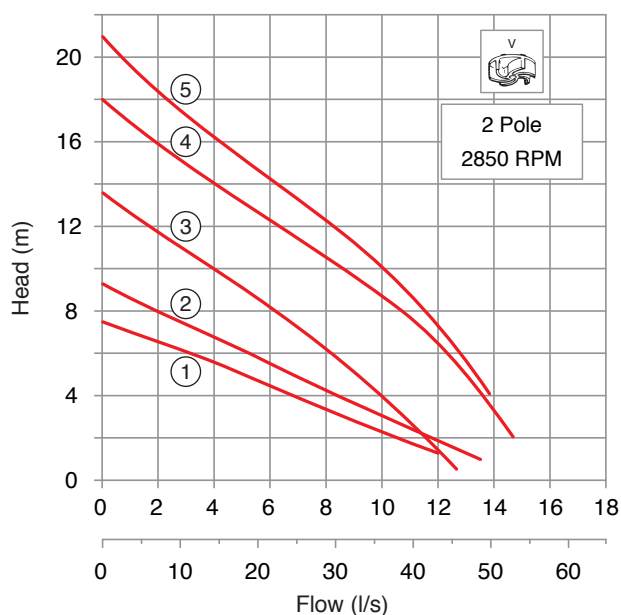

■ Technical table:

Curve no.	Pump model	Motor Power			Nominal Current (A)	Capacitor (µF)	Speed (rpm)	Solid Handling Capacity (mm)	Weight (kgs)
		P1 (kW)	P2 (kW)	HP					
6	ES50V 10/4 T (F)	1.1	0.8	1.0	2.4	-	1450	62	42
6	ES50V 15/4 M (F)	1.2	0.9	1.5	5.8	40	1450	62	42
7	ES50V 15/4 T (F)	1.3	1.0	1.5	2.6	-	1450	50	42
1	ES50V 20/2 M (F)	1.6	1.2	2.0	7.6	30	2900	65	29
2	ES50V 20/2 T (F)	1.6	1.2	2.0	2.9	-	2900	65	29
8	ES50V 20/4 T (F)	2.3	1.8	2.0	5.0	-	1450	62	47
3	ES50V 30/2 T (F)	2.6	2.1	3.0	4.5	-	2900	50	42
4	ES50V 50/2 T (F)	4.0	3.4	5.0	6.6	-	2900	50	47
5	ES50V 60/2 T	5.2	4.4	6.0	8.7	-	2840	50	58

\* **ES50V** - ES50 - Pump model, **V** - Impeller type | **XX/X** - Motor power/No. of poles | **M** - 230-240 V/1 Ph | **T** - 400-415V/3 Ph  
**F** - Optional float switch | **Capacitor** - Capacitor for applicable models is installed in the pump

■ Dimensional drawing:

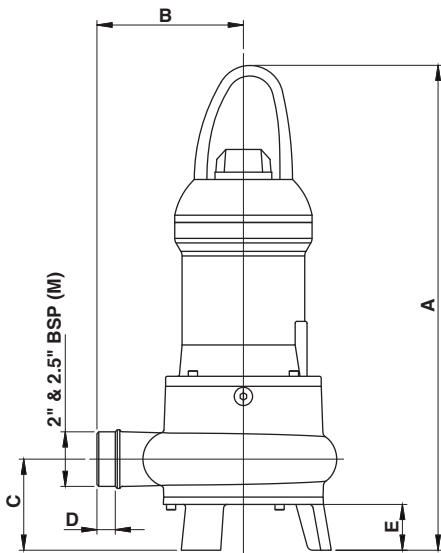

MODEL	A	B	C	D	E	F	G	H
ES50V 20/2	563	160	125	22	65	231	111	271
ES50V 15/4 T, ES50V 30/2	626	177	101	25	50	232	110	287
ES50V 10/4, ES50V 15/4 M	643	160	129	20	60	260	126	286
ES50V 50/2, ES50V 60/2	672	177	101	25	50	232	110	287
ES50V 20/4	689	177	101	25	50	232	110	287

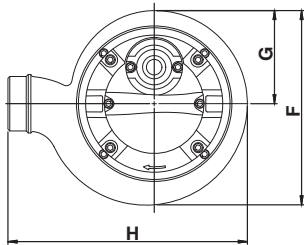

■ Pump accessories drawing:

Balloon no.	Item Description	Specification
1	Auto coupling kit	2.5"
2	Guide rail (G.I or SS)	Ø1"
3	Pump chain	-
4	Flanged pipe	2.5"
5	Swing check valve (Flanged)	2.5"
6	Swing check valve (Threaded)	BSP 2.5"
7	G.I male coupling	BSP 2.5"
8	Cast Iron gate valve (Flanged)	2.5"
9	Bronze gate valve (Threaded)	BSP 2.5"
10	90° flanged elbow	2.5"
11, 12	90° threaded elbow	BSP 2.5"
13	STORZ coupling	BSP 2.5"
14	Synthetic pressure hose with coupling	Ø65 mm

